

150 MM

18 MM

DS2



Prépercé pour utilisation avec des fixations invisibles
 Pre-drilled for use with concealed fixings
 Pretaladrado para usar con fijaciones ocultas
 Preforato per l'uso con fissaggi nascosti
 Pré-perfurado para uso com fixações ocultas
 Voorgeboord voor gebruik met verborgen bevestigingen
 Vorgebohrt für die Verwendung mit verdeckten Befestigungen

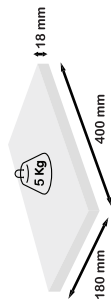
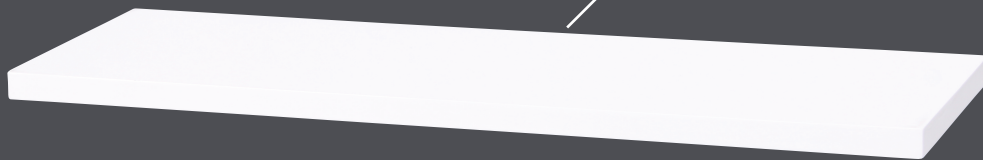

160 MM

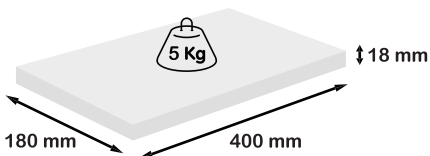

DS2

DS2

18 MM

40 MM

GB Material: MDF E1
 The maximum loads shown maybe lower depending on wall condition, Concealed fixings not included
 Screws and plugs not included

NL Materiaal: MDF E1
 De aangegeven maximale draagkracht kan lager zijn afhankelijk van de staat van de muur. Inclusief verborgen niet bevestigingsmateriaal. Schroeven en pluggen niet inbegrepen

IT Materiale: MDF E1
 I carichi massimi indicati forse inferiore a seconda delle condizioni della parete. Fissaggi invisibili non inclusi. Viti e tasselli non compresi

ES Material: MDF E1
 La carga máxima indicada puede ser menor dependiendo de la condición de la pared. Fijación oculta no incluidos
 Tornillos y tacos no incluidos

GE Material: MDF E1
 Abhängig von der Wandbeschaffenheit kann die maximale Belastbarkeit geringer als angegeben sein. Fixierungen invisibles nicht inbegriffen
 Schrauben und Dübel nicht im Lieferumfang enthalten

PG Material: MDF E1
 Carga máxima mostrada a baixo, depende das condições da parede. Fixações invisíveis não incluídas
 Parafusos e buchas não incluídos.

FR Matière: MDF E1
 La charge maximum dépend des conditions du mur.
 Fixations invisibles non incluses.
 Vis et chevilles non incluses.



809242
 Importé par Maretan
 www.maretan.com
 contact@maretan.com
 Batch code: xx/xx



18 MM

150 MM

1

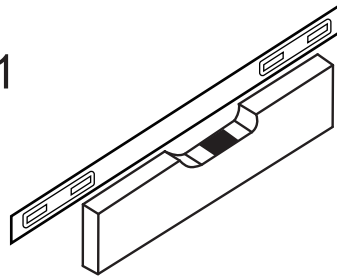

2

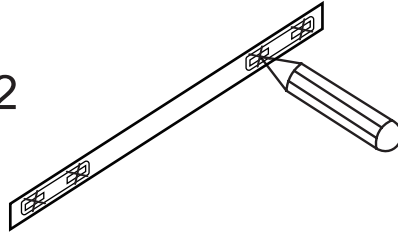

3

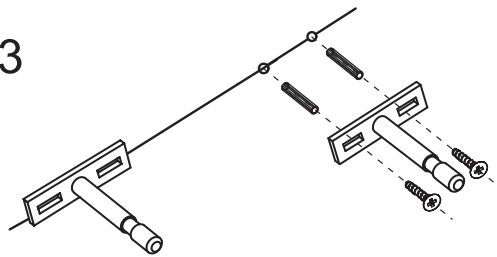

4

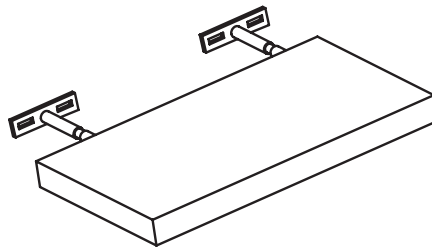

5

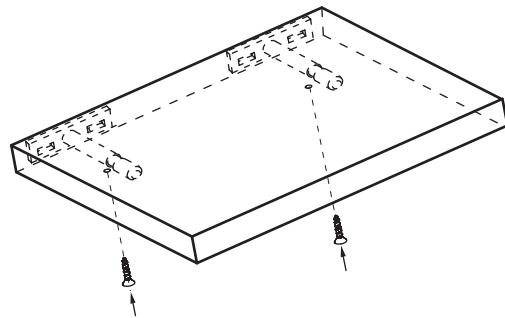

160 MM

18 MM

40 MM